

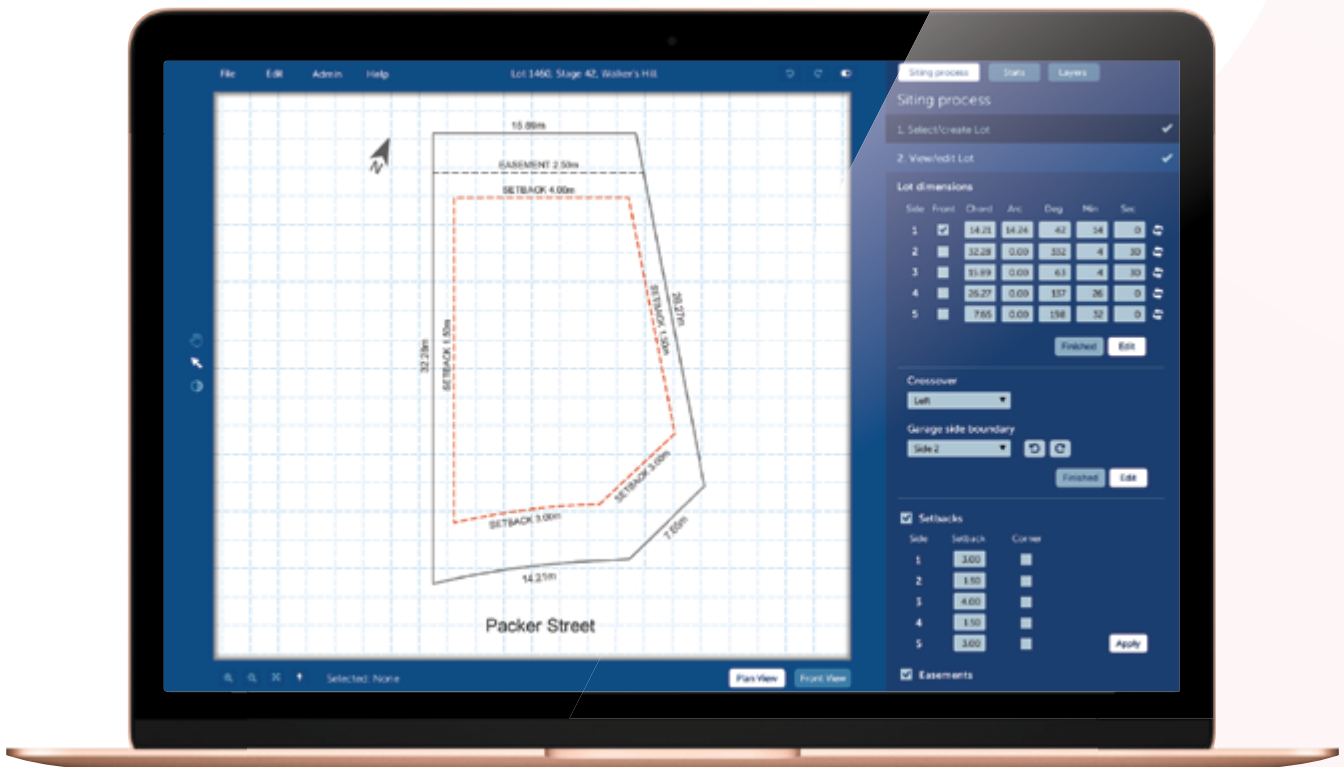

## Lot and Load offers 24 hour turnaround on new stages, including:

- ✓ Every lot in the stage plan
- ✓ Lot dimensions and area
- ✓ Easements
- ✓ Cross over
- ✓ Fall
- ✓ 3D envelope
- ✓ Setback
- ✓ Existing surface
- ✓ Finished surface
- ✓ Covenant rules



## Lot and Load Benefits



Allow Sales Agents to generate and publish packages.



Show package and siting options via Masterplans Unlimited.



Utilises Runway's existing package costs and covenant rules.



View all possible options before creating.